

# WLF-75A

## Non-follow-up handle

User manual



# User notice

---

## ► Disclaimer

**Warning:** Before using this product, please refer to the important safety information in the user manual and review all warnings, limitations and disclaimers.

This product is no substitute for proper training and careful seamanship. Proper installation and proper use of the equipment is the responsibility of the owner to avoid accidents, personal injury or property damage. The user of this product is solely responsible for compliance with maritime safety practices.

The owner is solely responsible for installing and using the equipment in a manner that will not cause accidents, personal injury or property damage. The user of this product is solely responsible for compliance with maritime safety navigation practices.

This document represents the product at the time of release. Ningbo SHANBEI Technology Co., Ltd. reserves the right to change product specifications at any time without prior notice. If you need any further assistance, please contact your nearest dealer.

## ► Governing language

This Statement, any instruction manuals, user guides and other Product-related information (documentation) may be or have been translated into another language (translation). If there is any conflict between any translated version of the document, the Chinese version of the document will be the official version of the document.

## ► Copyright

Ningbo SHANBEI Technology Co., LTD. All rights reserved.

## ► Cautions

- 1 Do not place the equipment at will without fixing it, so as to avoid serious damage when it is dropped due to turbulence or other factors during the voyage.
- 2 Do not use any power adapter that is not equipped with this product. Otherwise, the device may not work due to the different circuit design, or the performance may be affected or even damaged.
- 3 Do not disassemble the equipment. If the maintenance engineer is not authorized by the company to disassemble the equipment, the free warranty will be lost.
- 4 During use or cleaning, avoid any liquid or other objects falling into the equipment to avoid circuit damage or short circuit.
- 5 Do not place the device and its accessories in an environment prone to humidity or direct sunlight. Keep the device in a dry environment.
- 6 In case of hardware failure (such as damage to the machine shell or foreign matter falling into the machine, etc.), please stop using the machine immediately and contact the dealer in time.
- 7 The company shall not assume any legal or other liability for any maritime accident, monetary loss or loss of interests that occurs on vessels using this equipment.

# Contents

---

<b>1</b>	<b>Introduction</b>	<b>01</b>
1.1	Overview	01
1.2	Product appearance	01
1.3	Product composition	01
1.4	Product size drawing	01
1.5	Product wiring diagram	02
<b>2</b>	<b>Technical parameter</b>	<b>03</b>
2.1	Product basic parameter	03
<b>3</b>	<b>Installation instructions</b>	<b>04</b>
<b>4</b>	<b>Instructions and precautions for use</b>	<b>05</b>
4.1	Instructions for use	05
4.3	Matters needing attention	05
<b>5</b>	<b>Fault analysis and elimination</b>	<b>06</b>
<b>6</b>	<b>Safety protection and accident handling</b>	<b>07</b>
6.1	Safety protection devices and precautions	07
6.2	Troubleshooting procedures and methods	07
<b>7</b>	<b>Maintenance and repair</b>	<b>08</b>
7.1	Daily maintenance and maintenance	08
7.2	Operation precautions	08
7.3	Long-term maintenance and maintenance	08
<b>8</b>	<b>Transportation, storage and warranty</b>	<b>09</b>
8.1	Transportation precautions	09
8.2	Storage precautions	09
8.3	Warranty period	09
<b>9</b>	<b>Other</b>	<b>10</b>
9.1	Phone number of the after-sales engineer	10
9.2	Company information	10



# 1 Introduction

## 1.1 Overview

WLF-75A non-manual handle, also called emergency helmsman handle, is generally installed in the steering room, control console, bridge wings and other positions, used in the automatic, follow-up steering mode failure when the steering gear operation. The product uses engineering plastic shell beautiful and generous, ball handle is easy to hold, long life contact, with self-resetting spring, let go to return to the median and disconnect the output signal. The product has the following characteristics:

- 1. Innovative and convenient equipment connection solution, outstanding professional level; High reliability of product quality;
- 2. Customized according to customer needs, provide professional design support, high flexibility.

## 1.2 Product appearance



Figure 1.1

## 1.3 Product composition

Number	Name	Quantity
1	Non-follow-through handle	1
2	16 bit terminal	1
3	Certificate of conformity	1
4	Warranty card	1
5	Specification	1

Figure 1.1

# 1 Introduction

## 1.4 Product size drawing

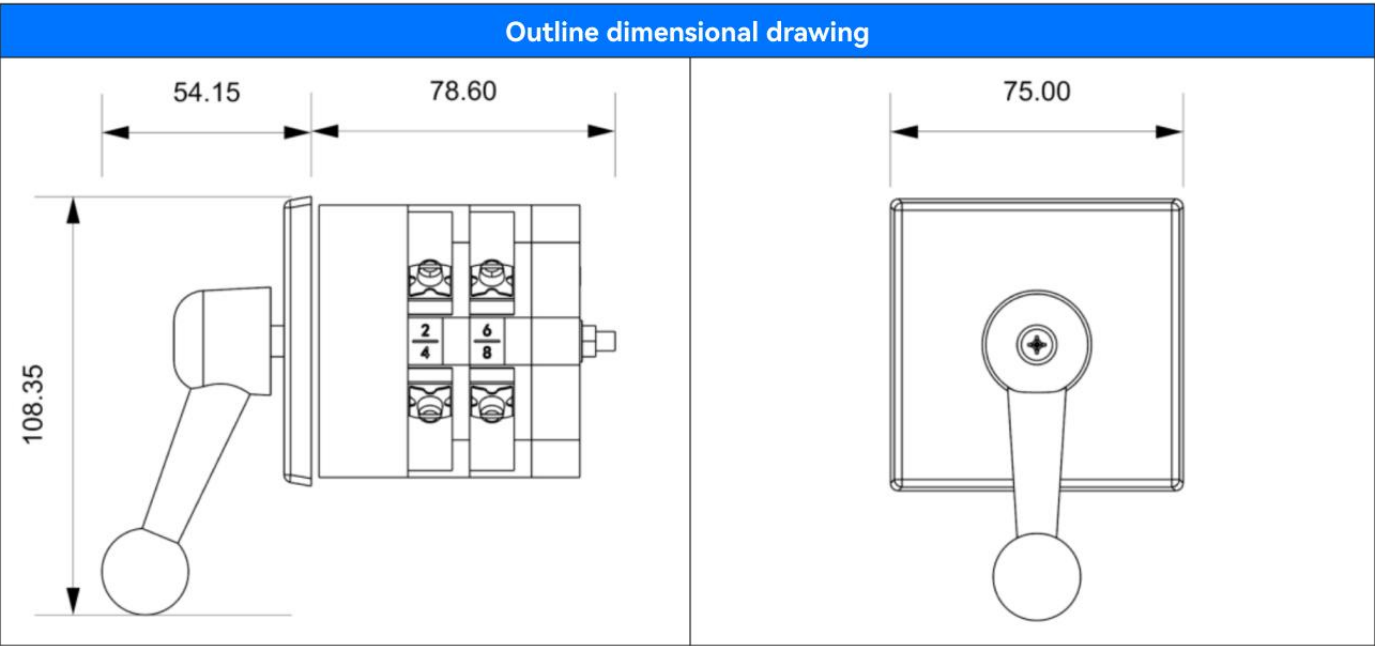

Figure 1.2

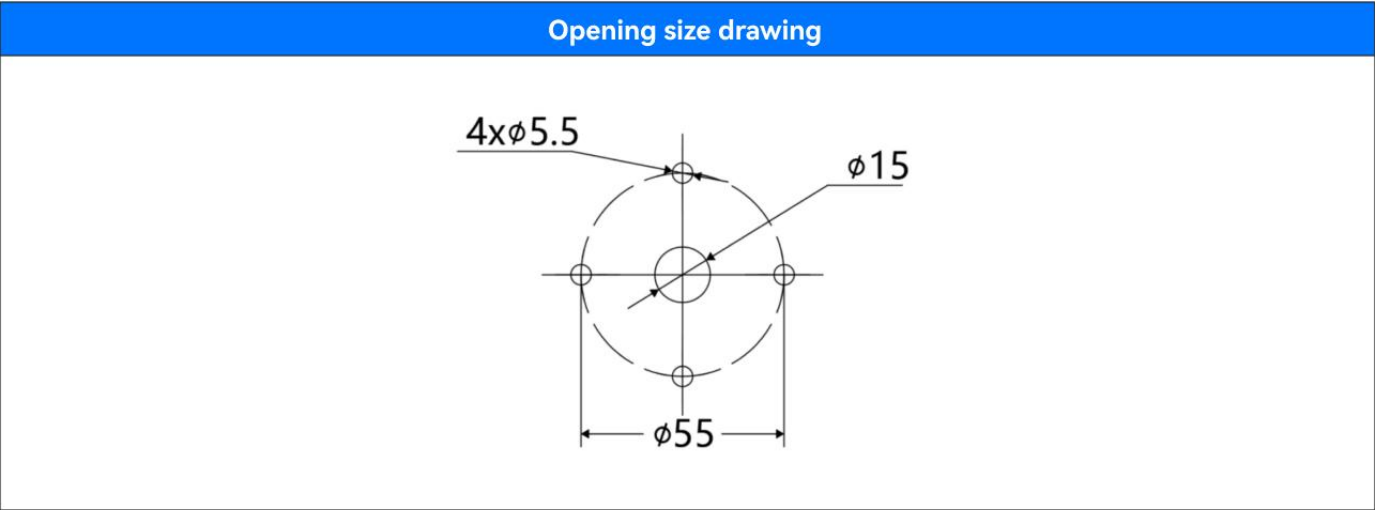

Figure 1.3

## 1.5 Product wiring diagram

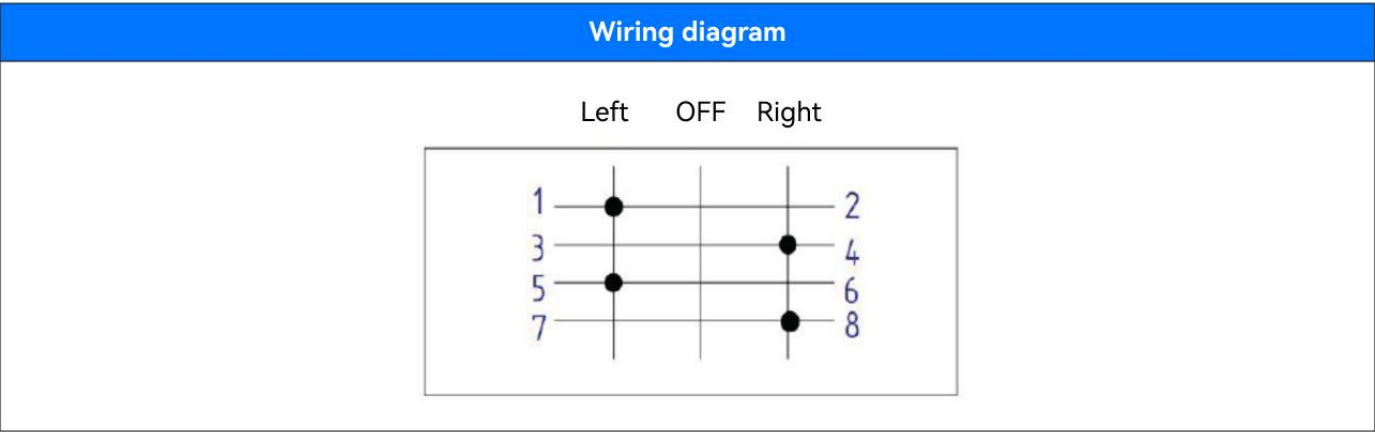

Figure 1.4

## 2 Technical parameter

---

### 2.1 Product basic parameter

Mechanical life	> 100,000 times
IP lever	IP54
Operating temperature	-20~70°C
Dimension	75*75mm
Weight	200g
Handle	Self-resetting

Table 2.1

### 3 Installation instructions

1. Remove part A, as shown in 3.1.

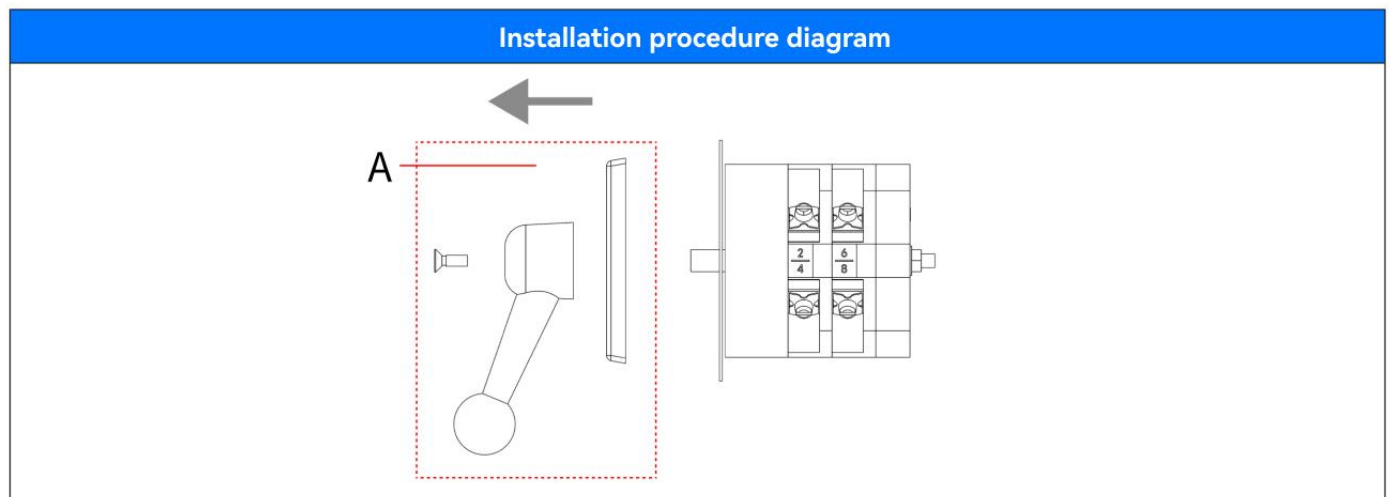

Figure 3.1

2. As shown in 3.2, install the main body inside the C mounting plate and part B outside the plate, and tighten the screws.

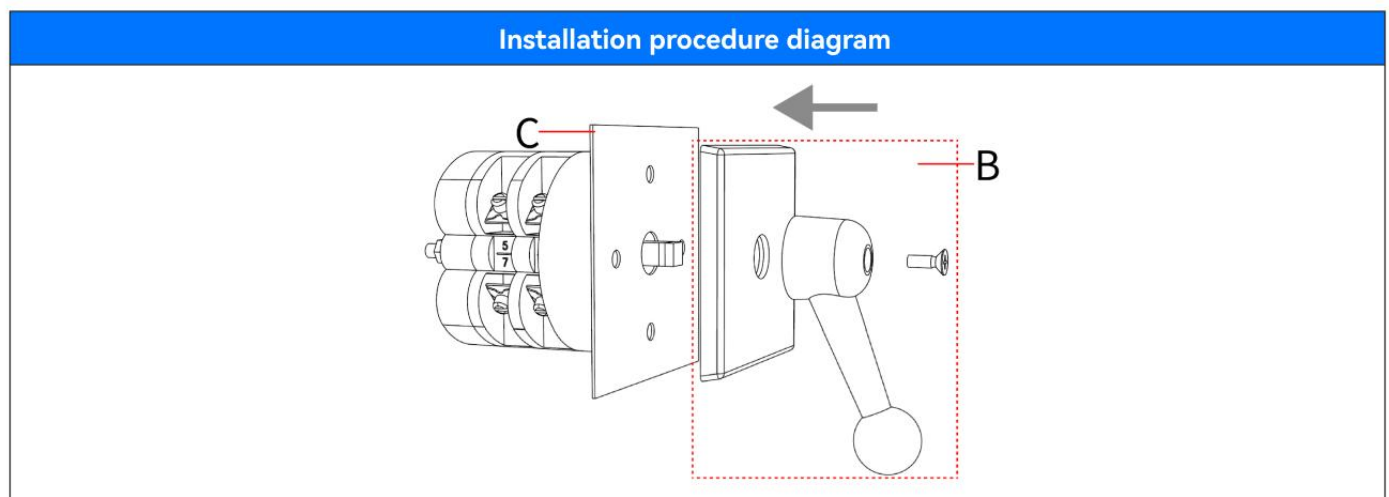

Figure 3.2

3. After installing the handle to the mounting plate, connect electrical cables. After the wiring is completed, it should be confirmed that the external wiring is firm and reliable.

4. Check the external cables, which should be connected normally; Turn the handle, the switch can complete the normal on-off action. After commissioning, disconnect the power supply.

## 4 Instructions and precautions for use

---

### 4.1 Instructions for use

1. Turn the handle to the corresponding position, the contacts are on, and the contacts in other positions are disconnected to realize the switch of the control loop.
2. Release the hand, automatically return to zero position, and all contacts are disconnected.

### 4.2 Matters needing attention

1. When the product reaches the mechanical life (about 100,000 times), it will not be able to self-reset, please replace it in time.
2. If it is not used according to the requirements in the instructions, the loss shall be borne by the user.



## 5 Fault analysis and elimination

---

This product has been put into operation since the use, basically no fault, with our statistics, the after-sales problem is basically due to wiring errors, resulting in normal use, in addition, there is no technical fault. Customers in the use of the process, if you find technical problems, please promptly communicate with our technical personnel.

## **6 Safety protection and accident handling**

---

### **6.1 Safety protection devices and precautions**

1. In the important position of this product, the fastening seals have been processed before leaving the factory, and shall not be disassembled without permission. If the seals are damaged, any product quality problems will be borne by the buyer.
2. Once the product fails to operate normally, please stop using and disconnect the power supply immediately, and contact our after-sales service engineer for a solution.

### **6.2 Troubleshooting procedures and methods**

1. In the process of use, there is an unsolvable fault problem, contact our after-sales service engineer.
2. During the warranty period, if the fault occurs due to the product itself, we will provide a complete replacement product and send it to the buyer for free replacement. And provide technical support; If the fault is not caused by the product itself, we can provide two options of complete replacement products and on-site services, which are selected by the buyer. All costs are borne by the recipient.
3. If the warranty period is exceeded and the fault occurs, we can provide two service options that can completely replace the product or replace some parts of the product, which are selected by the buyer. The required cost shall be borne by the purchaser.

# 7 Maintenance and repair

---

## 7.1 Daily maintenance and maintenance

In the daily non-use state, attention should be paid to the maintenance of this product. Through maintenance, maintenance can improve the service life of the product, the specific maintenance and maintenance methods are as follows:

1. Wipe the surface of the product regularly with a dry rag to ensure that the outside of the product is clean and tidy.
2. Disconnect the external power supply of the product, turn it back and forth regularly, repeat about 10 times, and the cycle is 2 to 3 weeks. It can ensure smooth operation and avoid "aging" phenomenon caused by long-term placement.

## 7.2 Operation precautions

1. Stop using the device when the control switch cannot position itself. Contact our after-sales engineer.
2. During the use, it should be carried out at a steady and uniform speed to avoid rapid rotation, and the impact of too fast speed will damage the product.
3. The input voltage shall be carried out in strict accordance with the wiring instructions. Failure to operate according to the regulations will cause product failure or other major accidents, which shall be borne by the buyer.

## 7.3 Long-term maintenance and maintenance

Long-term placement, maintenance maintenance methods, and daily maintenance, maintenance methods are the same.

## **8 Transportation, storage and warranty**

---

### **8.1 Transportation precautions**

Physical damage to the product caused by violent shaking and collision should be avoided during transportation.

### **8.2 Storage precautions**

Room temperature, dry, cool environment. Avoid high temperature exposure or low temperature freezing, which will cause irreversible damage to the damping parts and reduce the service life.

### **8.3 Warranty period**

The warranty period of this product is 12 months from the date of receipt of the goods by the buyer. Based on the date of receipt of documents for express delivery or the date of receipt of invoice.

## 9 Other

---

### 9.1 Phone number of the after-sales engineer

Contact: Mr.Xu

Tel: 18067343163

### 9.2 Company information

Manufacturer: Ningbo SHANBEI Technology Co., LTD

Address: A2-902, R&D Park, High-tech Zone, Ningbo

Postal Code: 310001

Tel: (0574) 87182781

Fax: (0574) 87182781



For more information, please visit:

[en.shanbei-tech.com](http://en.shanbei-tech.com)

---

**Ningbo Shanbei Technology Co.,Ltd**

**Address:** 902 Area A, R&D Park, High-tech Zone, Ningbo, Zhejiang, China

**WhatsApp:** +86 13186888051

**E-mail:** 3667568441@qq.com

**Wechat:** 13186888051

**WhatsApp** →

